

Classic high-end fabric dome midrange with a neodymium ring magnet system.

Custom fabric dome manufactured to SEAS' specifications. This lightweight material with special coating provides superior sound quality.

The FEA-optimized motor system features a NdFeB magnet ring, a well-damped vented pole piece, and a rigid rear chamber. This design ensures a low resonance frequency and smooth response, while the overhung voice coil minimizes distortion.

Copper Clad Aluminium voice coil wound around a ventilated aluminium former for high sensitivity and low noise. Flexible lead out wires prevent lead breakage due to the large excursions encountered when low crossover frequencies are used.

A 7 mm thick precision machined aluminium front plate with a very slight horn loading ensures linear frequency response and provides an extremely stable platform for the magnet system and the moving parts.

The M64F001 dome diaphragm offers a smooth roll-off at both ends of the frequency spectrum, making it an ideal unit for seamless integration with other drivers.

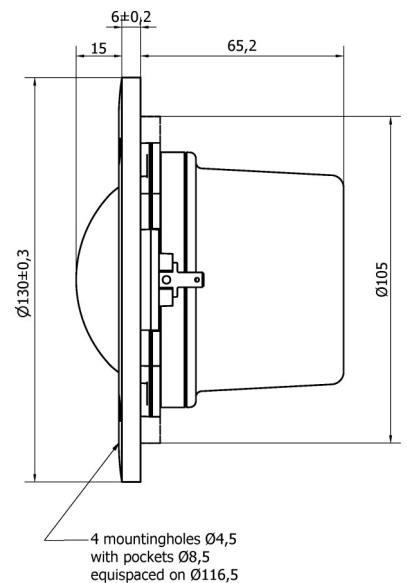
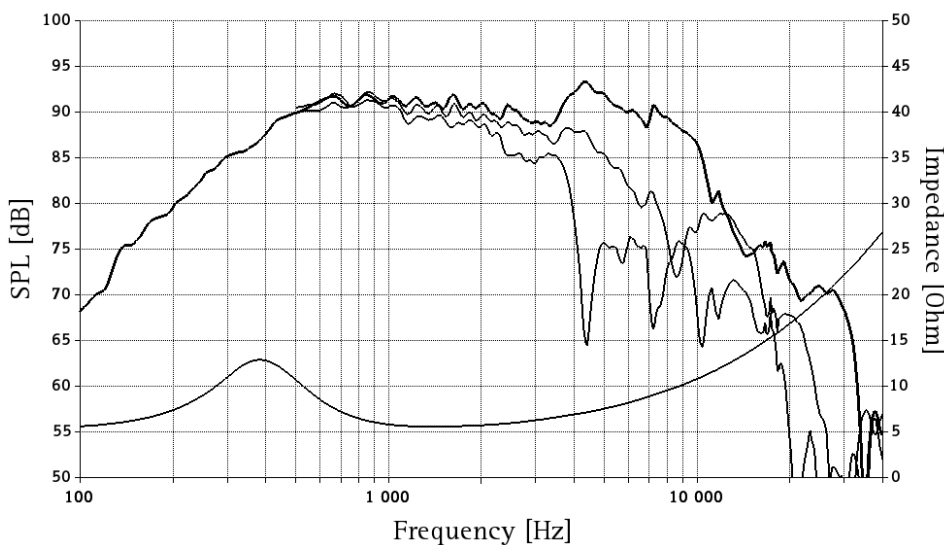

The frequency responses above show measured free field sound pressure in 0, 30, and 60 degrees, mounted in a IEC standard baffle (1.35m by 1.65m). Input 2.83 Vrms, microphone distance 0.5m, SPL normalized to 1m. The impedance is measured without baffle using a 2V sine signal.

Nominal Impedance	6 Ohms	Voice Coil Resistance	4.8 Ohms
Recommended Frequency Range	350 Hz - 10 kHz	Voice Coil Inductance	0.13 mH
Short Term Power Handling *	350 W	Force Factor	6.3 N/A
Long Term Power Handling *	150 W	Free Air Resonance	377 Hz
Characteristic Sensitivity (2,83V, 1m)	92 dB	Moving Mass	3.0 g
Voice Coil Diameter	63.7 mm	Effective Piston Area	41.2 cm ²
Voice Coil Height	4.0 mm	Magnetic Gap Flux Density	1.1 T
Air Gap Height	2.6 mm	Magnet Weight	70 g
Linear Coil Travel (p-p)	1.4 mm	Total Weight	0.55 kg

March 2026

*IEC 268-5, via High Pass Butterworth Filter 500Hz 12dB/oct.
SEAS reserves the right to change technical data